

KENDALL CAMP DESIGNATED PARKING SPACES

UNIT # Street Address	PARKING SPACES (4 PER UNIT)			
1 31 Kendall Camp Cr.	1	2	67	95
2 33 Kendall Camp Cr.	3	4	68	96
3 51 Kendall Camp Cr.	5	6	53	94
4 53 Kendall Camp Cr.	7	8	54	93
5 71 Kendall Camp Cr.	9	10	55	92
6 73 Kendall Camp Cr.	11	12	56	91
7 91 Kendall Camp Cr.	13	14	57	90
8 93 Kendall Camp Cr.	16	17	58	89
9 101 Kendall Camp Cr.	15	18	59	88
to 103 Kendall Camp Cr.	19	20	60	87
11 121 Kendall Camp Cr.	21 & 21B (No Garage)	22	61	86
12 123 Kendall Camp Cr.	23	24	62	85
13 141 Kendall Camp Cr.	25	26	63	84
14 143 Kendall Camp Cr.	27	28	64	77
15 161 Kendall Camp Cr.	29	30	65	78
16 163 Kendall Camp Cr.	31	32	66	79
17 181 Kendall Camp Cr.	33	34	80	81
18 183 Kendall Camp Cr.	35	36	82	83
19 170 Kendall Camp Cr.	37	38	74	76
20 200 Kendall Camp Cr.	39	40	73	75
21 254 Kendall Camp Cr.	41	42	69	97
22 46 Kendall Camp Cr.	43	44	70	98
Unassigned Spaces - Overflow	71	72	99	100
	101	102	103	104

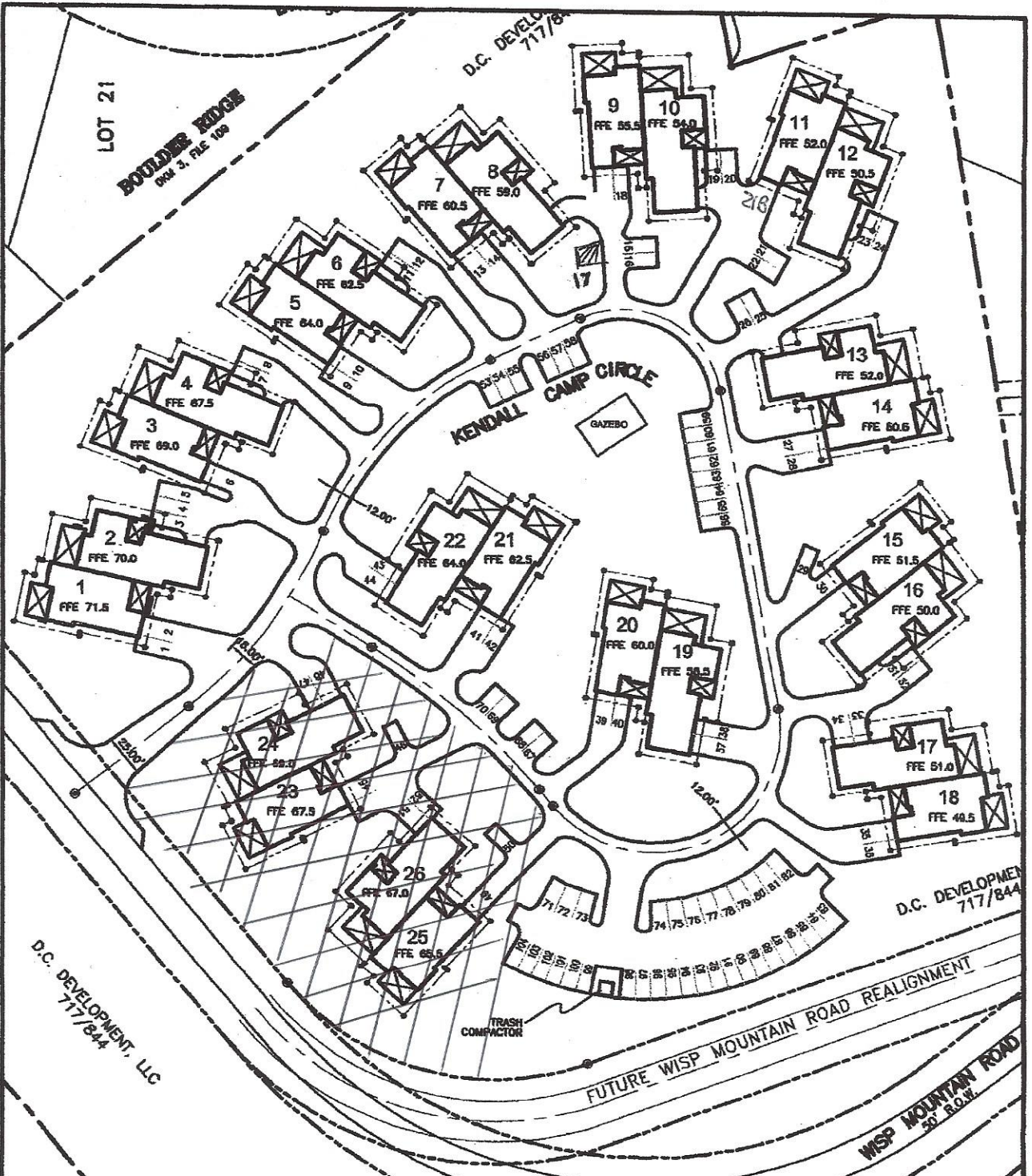

**HIGHLAND
ENGINEERING &
SURVEYING, INC.**

Telephone: 301-334-6185
Facsimile: 301-334-8317

1426 Memorial Drive
Oakland, Maryland 21550

EXHIBIT FOR
**KENDALL CAMP
PARING ASSIGNMENTS**
ELECTION DISTRICT NO. 6, GARRETT COUNTY, MARYLAND
SCALE: 1" = 80'
DATE: AUGUST 2007